

# Campus Map



**Mobile Infirmiry**  
INFIRMARY HEALTH



Visiting hours are posted  
at the front lobby.

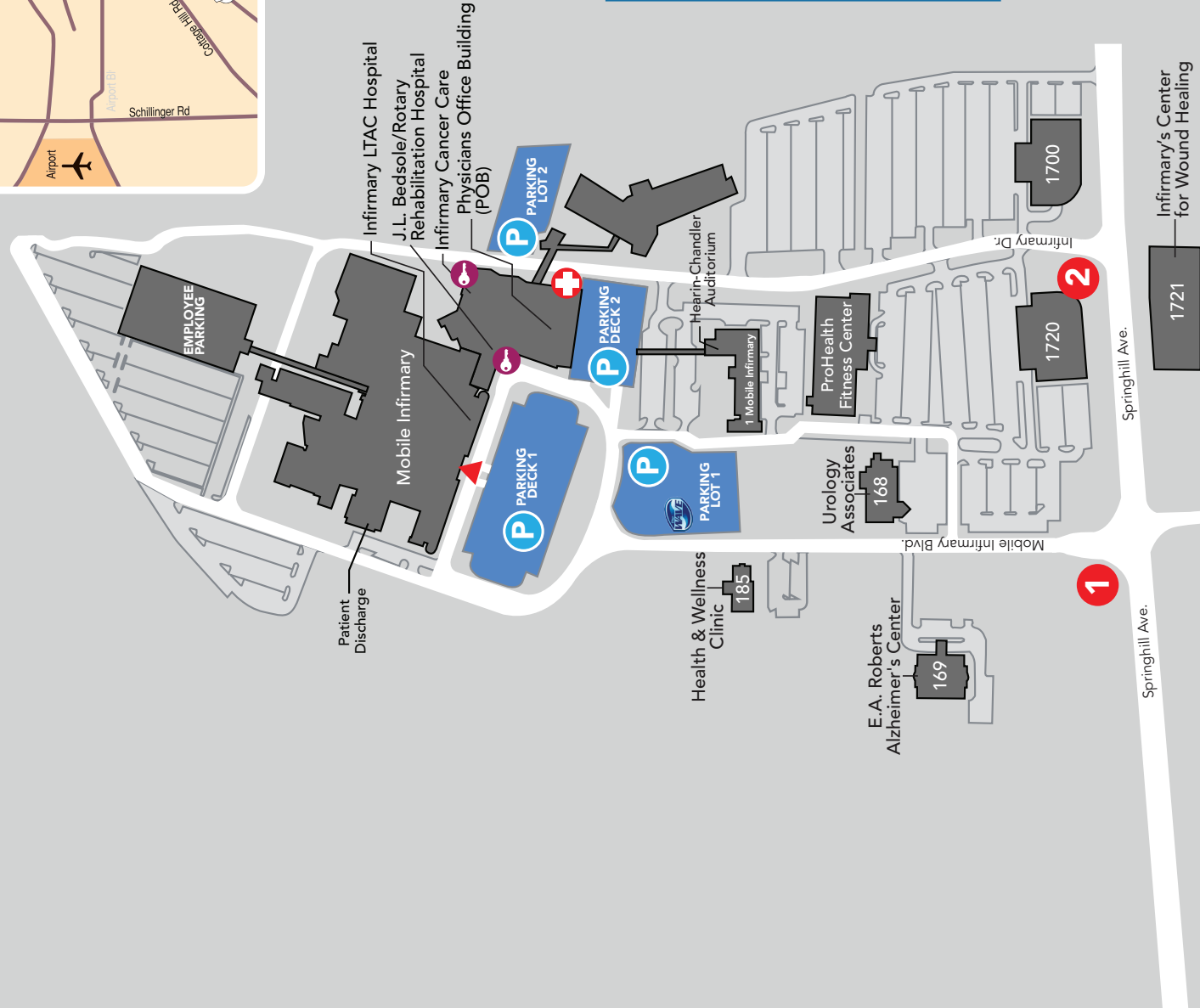
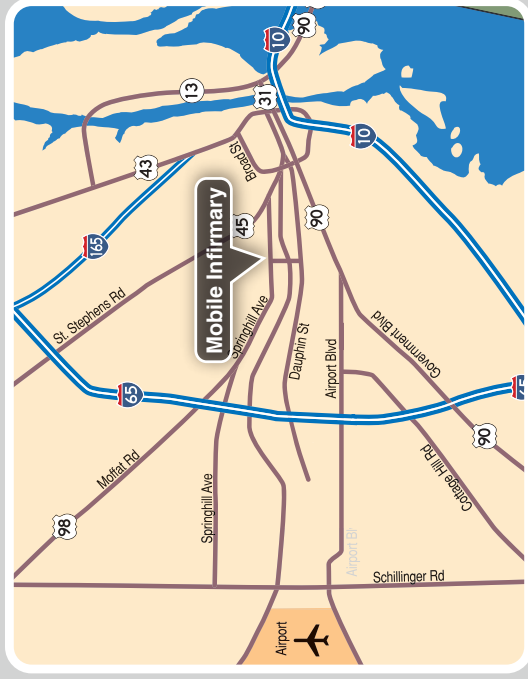

**Mobile Infirmiry**  
INFIRMARY HEALTH

# Visiting hours are posted at the front lobby.

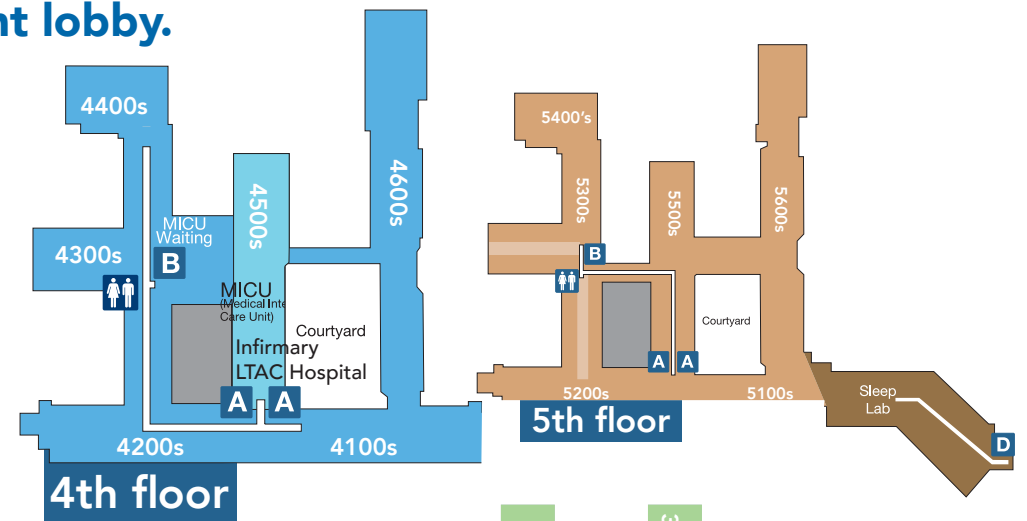
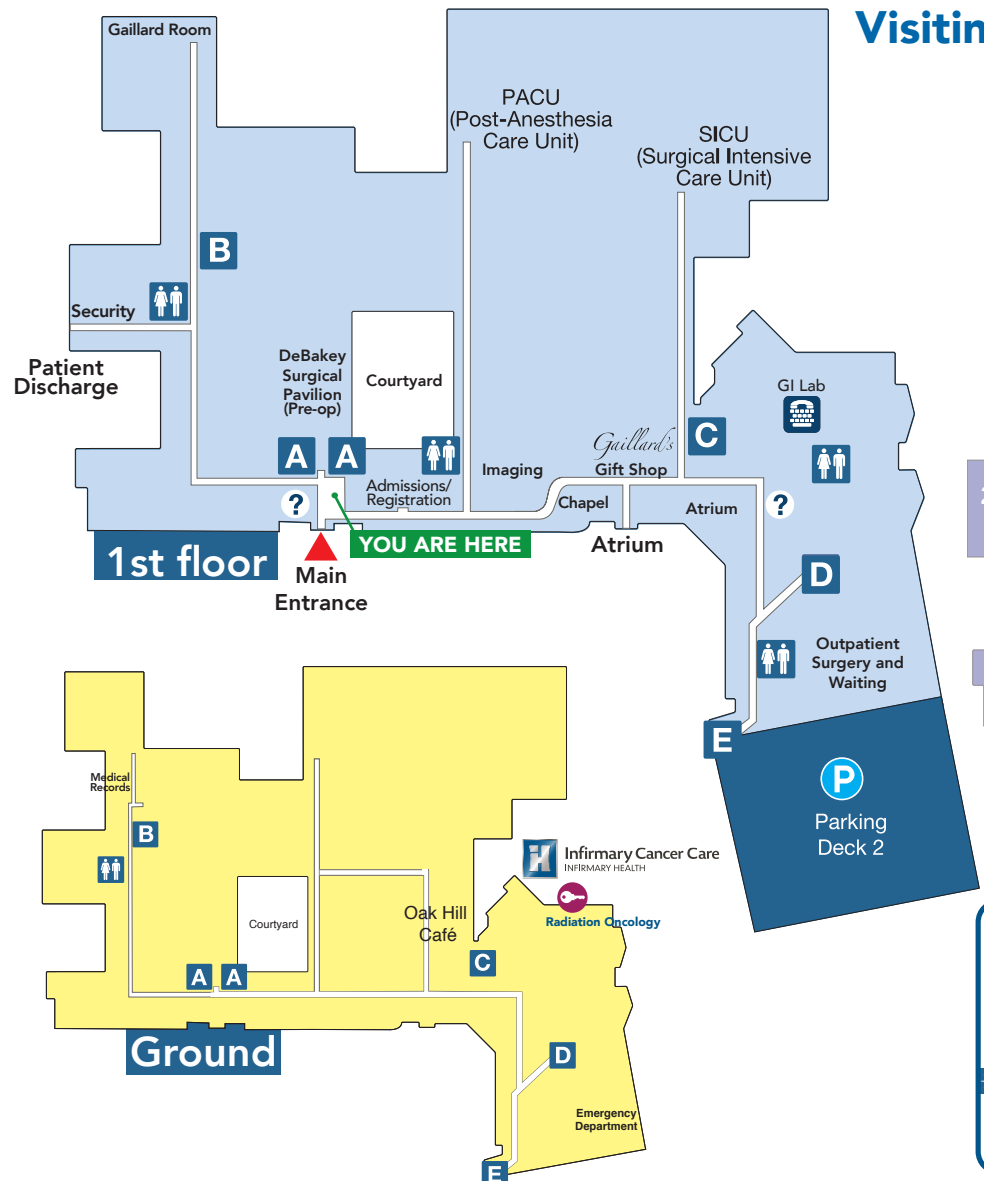

Map Key	
Elevator Landmarks	A B C D E
Entrances	▶
Information	?
Parking Deck	P
Pathway (hallways & corridors)	—
Restrooms	♂ ♀
TTY	♂ ♀

G Floor			1 Floor			2 Floor			3 Floor			4/5 Floor		
Location	Floor	Elevator	Location	Floor	Elevator	Location	Floor	Elevator	Location	Floor	Elevator	Location	Floor	Elevator
Auditorium	Ground	A	Admissions/Registration	First	A	2100s, 2200s, 2700s, 2800s	Second	A	3100-3200s	Third	A	4100s, 4200s	Fourth	A
Emergency Department	Ground	E	Chapel	First	A	2300s, 2400s	Second	A	3300s, 3400s, 3500s	Third	B	4300s, 4400s	Fourth	B
MRI/CT Scan	Ground	C	DeBaKey Surgical Pavilion (Pre-Op)	First	A	Family Plaza	Second	B	3600s, 3700s, 3800s	Third	C	4500s, 4600s	Fourth	A
Oak Hill Café	Ground	A	Gaillard's Gift Shop	First	A	Childbirth Education Classroom	Second	B	Coronary Care Unit (CCU)	Third	B	Medical Intensive Care Unit (MICU)	Fourth	B
Pulmonary Services	Ground	A	Outpatient Surgery and Waiting	First	A	Labor and Delivery	Second	B	Electrodiagnostics	Third	A	Infirmary LTAC Hospital	Fourth	A
Radiation Oncology	Ground	C	Post Anesthesia Care Unit (PACU)	First	A	Newborn Nursery	Second	A	Cardiac Cath Lab	Third	B	5200s	Fifth	A
Medical Records	Ground	B	Surgical Intensive Care Unit (SICU)	First	A	Neurodiagnostics	Second	A	J.L. Bedsole/Rotary Rehabilitation Hospital	Third	C	5300s	Fifth	B
Infirmary Cancer Care	Ground	C	Admit/Discharge Lounge	First	A	Neuro Intensive Care Unit (NICU)	Second	B				5500s, 5600s	Fifth	A
			GI Lab	First	A							Sleep Lab	Fifth	D